

# Enviro Flex FL

## FLEXIBLE WATERPROOFING POLYURETHANE SEALANT

**Enviro Flex FL** is a one-component fast curing high performance elastomeric joint sealant based on moisture cured polyurethane technology. Enviro Flex FL is designed for use under waterproofing membranes as a cove joint for movement junctions such as floor wall junctions.

### FEATURES AND BENEFITS

- ✔ Excellent adhesion
- ✔ Rapid skin and curing
- ✔ UV stable
- ✔ Long term durability
- ✔ Excellent bi-axial flexibility
- ✔ Chemical resistance
- ✔ Very low VOC content
- ✔ Low dirt pick up
- ✔ Non-staining
- ✔ Paintable after cure
- ✔ No shrinkage
- ✔ Non-sag
- ✔ Vibration and sound dampening properties

### APPLICATION SOLUTIONS

Enviro Flex FL can be used for sealing internal corners between building components such as concrete panels, fibre cement sheets, block and brickwork, and around window and door frames prior to membrane application. Enviro Flex FL is suitable for commercial and residential, internal and external applications.

- ✔ Internal and external wet areas
- ✔ Basements, walls and floors
- ✔ Plant rooms
- ✔ Planter boxes
- ✔ Bathrooms
- ✔ Podiums
- ✔ Balconies
- ✔ Retaining Walls
- ✔ Prisons, schools and public amenities

### PRODUCT INFORMATION

**Packaging:** Enviro Flex FL is supplied in a 600ml sausage, 20 sausages per carton.

**Shelf life:** Enviro Flex FL can be stored in its original sealed containers for 12 months in controlled environments. This does not affect the performance of the product. Enviro Flex FL is sensitive to airborne moisture. It is preferable to use all contents of a sausage after opening. Always check product quality before using after prolonged periods of storage. If unsure, please contact EnviroSystems for advice.



SEALANTS



## Directions for Use

### SUBSTRATE PREPARATION

All defective host substrate must be removed prior to application. Defective material includes cracked or structurally weakened surfaces and chloride contaminated and carbonated concrete .

All surfaces must be free of dust, oils, and surface contaminants. This may require steam cleaning or high-pressure water blasting.

Enviro Flex FL is suitable for use over the following substrates:

- ④ Concrete - cured for min. 28 days,  
under 4.5% moisture (gravimetric method)
- ④ Renders - cured for min. 7 days  
under 4.5% moisture (gravimetric method)
- ④ Timber
- ④ Masonry substrates - brick, blocks, etc.
- ④ Fibre cement sheets
- ④ Aluminium

*NOTE: Do not apply Enviro Flex FL to any concrete that has received concrete artificial curing compounds or aluminium that may have been treated. Do not apply sealant where there is high humidity or when rain is anticipated within 2 hours of application. Not suitable for contact with bitumen or bituminous products.*

*NOTE: Test oil based paints prior to application for suitability. Some substrate preparations may initially require mechanical grinding in order to provide an adequate surface profile and to promote optimum adhesion for the membrane system.*

For further information on substrate preparation or for project specific advice, please consult Enviro systems.

### PRIMING

Enviro Flex FL achieves excellent adhesion to suitably prepared substrates without the use of primers. However, for critical applications adhesion may be improved with the use of an approved primer. Contact Enviro systems for recommendations on approved primers.

*NOTE: For further information on applications that may not require priming or for project specific advice, please consult Enviro systems.*

### APPLICATION

Enviro Flex FL is to be applied using an appropriate caulking/sausage gun. Cut one end of the sausage, place the plastic nozzle on the cut end and insert the sausage into a manual or electric gun. The plastic nozzle should be cut at an angle to achieve the desired bead thickness and profile.

Fit the sausage into a manual or pneumatic air operated gun (provided with telescopic piston) and extrude the adhesive/sealant carefully preventing air entrapment.

Once opened, sausages should be used up within a relatively short time. Apply Enviro Flex FL firmly into the internal corner or joint and tool to the required cove size as per the relevant Australian Standard.

For further information regarding application of Enviro Flex FL or for project specific advice please consult Enviro systems.

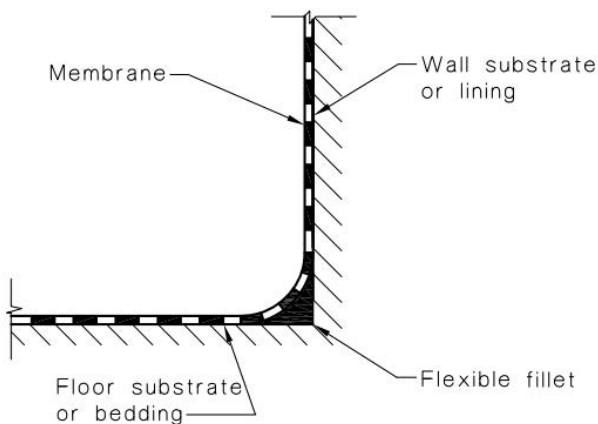

### COVERAGE

The coverage of Enviro Flex FL will depend on the type of substrate, the substrate conditions and the size of the cove. When prepared and primed in accordance with the instructions above, the following coverage rates should be expected:

8 lineal metres (12mm x 12mm cover) per 600mL sausage. For a joint of 12mm width and 12mm deep, the coverage is 4.2m per sausage.

## Product Data

### PHYSICAL PROPERTIES

PROPERTY	
Appearance	Thixotropic paste
Colour	Grey
Curing Mechanism	Moisture curing
Curing Through Volume	2.0 - 3.0mm/day @ 23°C @ 50%RH
Shore A	40 - 50 @ 23°C @ 50%RH
Density	1.35 ±0.02g/cc @ 23°C @ 50%RH
Tack Free Time	45 - 60 min (approx.)
Elastic Modulus	≥0.6N/mm <sup>2</sup> @ 100%
Tensile Strength	≥1.9N/mm <sup>2</sup> ISO 37 DIN53504
Elongation	≥450%
Application Temperature	5°C - 40°C
Temperature Resistance	-40°C to 90°C, up to 120 min

### CHEMICAL RESISTANCE

Good resistance to water, weak acids, weak alkalis, sewerage, mineral oils, vegetable oils, fats, fuels. (Not resistant to organic solvents, paint thinner, strong acids, strong alkalis).

### CLEANING

Enviro Flex FL should be removed from all tools and equipment, prior to hardening with Enviro Thinners No.1 or No.7. Observe all OH&S and Safety Data Sheet information pertaining to the safe usage and handling of solvents. Cured material can only be removed mechanically.



## Contact Enviro systems

### NEW SOUTH WALES - HEAD OFFICE

Ground Floor, 295 Princes Highway, St Peters NSW 2044 | [info@enviro systems.com.au](mailto:info@enviro systems.com.au)

### QUEENSLAND

Unit 3, 28 Burnside Road, Yatala QLD 4207 | [info@enviro systems.com.au](mailto:info@enviro systems.com.au)

### VICTORIA

49 Wood Street, Thomastown VIC 3074 | [info@enviro systems.com.au](mailto:info@enviro systems.com.au)

### WESTERN AUSTRALIA

78 Discovery Drive, Bibra Lake WA 6163 | [perth@enviro systems.com.au](mailto:perth@enviro systems.com.au)

### PHONE

1300 WATERPROOF (928 377)

#### HEALTH & SAFETY ADVICE

Enviro Flex FL contents are flammable. Keep away from naked flame. In the event of fire, extinguish with foam or CO<sub>2</sub>. Always provide adequate ventilation and wear appropriate Personal Protection Equipment (PPE) during use. Avoid breathing vapours and contact with skin. If swallowed, DO NOT induce vomiting, give a glass of water and seek immediate medical advice. If contact with skin, wash off splashes of material with clean water and soap. If irritation occurs seek immediate medical advice. Refer to the Safety Data Sheet for full safety and handling procedures.

*NOTE: Safety Data Sheets are available upon request.*

#### KEEP OUT OF REACH OF CHILDREN

#### STATEMENT OF RESPONSIBILITY

The technical information and application advice given in this publication is based on the present state of our best knowledge. As the information herein is of a general nature, no assumption can be made as to a product's suitability for a particular use of application and no warranty as to accuracy, reliability or completeness either expressed or implied is given other than those required by Commonwealth or State Legislation. The owner, his representative or the contractor is responsible for checking the suitability of products for their intended use.

*NOTE: Field service where provided, does not constitute supervisory responsibility. Suggestions made by Enviro systems either verbally or in writing may be followed, modified or rejected by the owner, engineer or contractor since they, and not Enviro systems are responsible for carrying out procedures appropriate to a specific*

*NOTE: All products manufactured by Enviro systems comply with the description and properties indicated in the technical data sheet that was current at the date of manufacture.*